

ONE  
TWO  
THREE

SO BROAD

123 S. Broad Street

# Duke & Duke Boardroom



Located on the 5th floor of 123 S. Broad Street, spanning the entire city block between Walnut and Sansom Streets, you will find the Duke and Duke Boardroom.

This premier space, including an ancillary 1,000 square foot lounge, is available for meetings and events ranging in size from 20 to 120 people. The almost 1,300 square foot Duke and Duke Boardroom boasts 22-foot-high ceilings and original wood flooring, restored meticulously, from the 1920s. Large windows overlooking Broad Street allow for ample natural daylight. Equipped with Wi Fi and audiovisual capabilities, including a 98-inch monitor suitable for bring your own device connection, the Duke and Duke Boardroom is the premier place to host your next business meeting, luncheon, or event.

## Floor Plan & Layouts

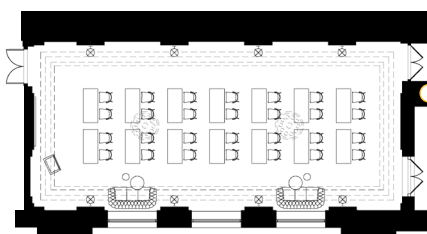

CLASSROOM  
STYLE  
CAPACITY: 50

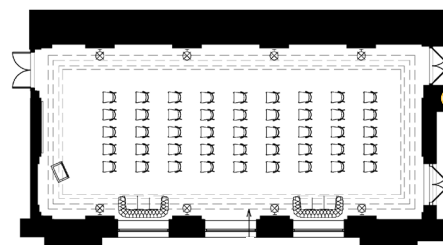

THEATER  
STYLE  
CAPACITY: 100

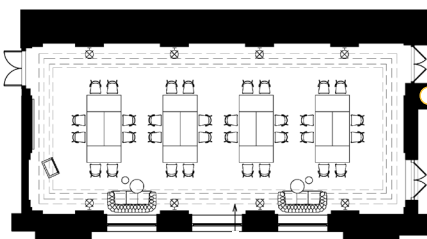

ROUNDTABLE  
& BREAKOUT  
TRAINING  
CAPACITY: 32

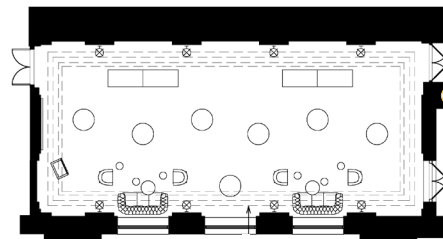

COCKTAIL  
RECEPTION  
*Furniture for this  
layout not included*  
CAPACITY: 120

## Additional Layouts *(Not Pictured Above)*

U-SHAPE \_\_\_\_\_ CAPACITY: 55

SQUARE \_\_\_\_\_ CAPACITY: 60

SEATED RECEPTION (72-INCH ROUNDS) \_\_\_\_\_ CAPACITY: 70

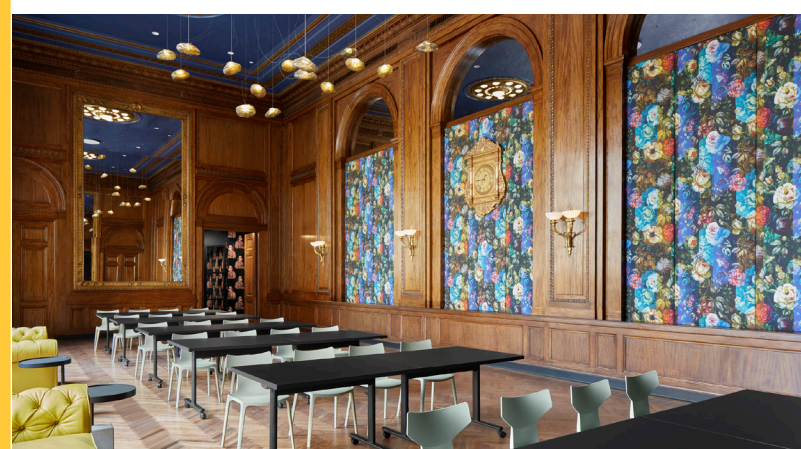

Request to book by contacting the 123 S. Broad Events Team at:  
[events123@sshco.com](mailto:events123@sshco.com) or 215-893-3000 ext. 149

REQUEST TO BOOK



## Layout: Duke & Duke Board Room & The Gallery



Request to book by contacting the 123 S. Broad Events Team at:  
[events123@sshco.com](mailto:events123@sshco.com) or 215-893-3000 ext. 149

**REQUEST TO BOOK**

The information contained in this brochure is intended for general information purposes only. The information presented is subject to change at any time.